

**ARCHITECTURE
WINNERS OF OUR
2003 AWARDS (P.57)**

The McGraw-Hill Companies

BusinessWeek

NOVEMBER 3, 2003

www.businessweek.com

CARTER & BURGESS, INC

Nearly 40 years after debuting as one of the South's first fully enclosed shopping centers, Raleigh's North Hills Mall is poised to once again make history. By uniting the new North Hills with an adjacent development, The Lassiter, a new upscale lifestyle destination will be created becoming the



fast-growing Research Triangle area's first high-density mixed-use project.

Carter & Burgess is providing master planning, architectural design and engineering services for Kane Realty Corporation's redevelopment program, which transforms the 30-acre mall site and expands The Lassiter, creating a pedestrian oriented village with more than 690,000 square feet of restaurants and retail shops

oriented around a town square and a pair of shopping streets. Anchoring the development will be two national retailers, a 14-screen cinema, a four-star hotel and 300,000 square feet of office space.

At The Lassiter (the former North Hills Plaza), a 300-unit courtyard apartment complex will be situated above ground floor shops and a parking structure along with an adjacent 65-unit luxury condominium tower. Both

Baltimore, MD • 410.727.6773 • www.c-b.com

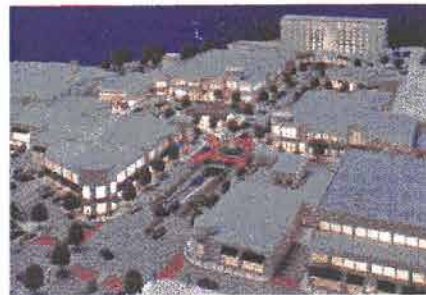

will rise around the recently renovated original plaza building, which will contain an upscale grocery, drug store, dry cleaners and other neighborhood-oriented services.

Carter & Burgess adapted the project design to the site's topography putting a new twist on the "inside out" mall renewal strategy. A structured parking deck

incorporated between the anchor stores becomes the podium for the tree-lined town square and shopping streets that seamlessly link to The Lassiter and surrounding roadways. Angled street parking, lush landscaping and masonry walkways will provide convenience and a pleasantly scaled, urban environment.

With demolition complete and construction underway, the North Hills/Lassiter project is on track for completion in late 2004.

Nixon & Laird Architects/Engineers, P.C., an entity related to Carter & Burgess, Inc., provided all architectural services.



Carter & Burgess